

TRAFFIC CONTROL NOTES

- These traffic control plans were developed for the Commercial Street Waterline Improvements project. These plans will cover a major portion of the work involved on this project. The Contractor has the option of developing their own traffic control plan and submitting it to the Engineer for review and approval (at least two weeks prior to proposed implementation).
- All traffic control devices (signs, barricades, drums, channelizers, etc.) shall be provided, erected and maintained by the Contractor and shall conform to the most recent Manual on Uniform Traffic Control Devices (MUTCD) and the AASHTO Roadside Design Guide. The Contractor shall be responsible for maintaining in position, cleaning, and replacing damaged traffic control devices.
- The Engineer shall determine the final location of all traffic control devices.
- Damage by construction activities to existing pavement markings and/or existing traffic signs that are to remain shall be replaced by the Contractor at no additional expense to the Owner.
- Restriction of on-street parking along Commercial Street will only be allowed on one side of the street at a time. The Contractor and their subcontractors, material suppliers and any other representative of the Contractor shall not park vehicles and/or equipment within the on-street parking areas that remain open adjacent to the work zone.
- Temporary Traffic Control:**
 - Two-way (north/south) traffic shall be maintained at all times on Commercial Street (K-99). Construction activities that require one of the driving lanes on Commercial Street (K-99) to be shifted shall conform to these traffic control plans and Traffic Control Notes.
 - KDOT Standard TE720 shall be used for construction activities located in parking areas/shoulders that do not require narrowing or shifting of the driving lane(s) on Commercial Street (K-99).
 - Two-way (east/west) traffic shall be maintained at all times on side streets (except 6th Avenue and 12th Avenue) intersecting Commercial Street (K-99) with exception of when construction activities are located within the intersection and require side street closure. See these traffic control plans for more information regarding typical traffic control for side streets OPEN through work zone and side streets CLOSED at work zone.
 - Short duration activities such as Disconnections/Connections located in the center of an intersection shall conform to the MUTCD Typical Application "TA-26" for Closure in the Center of an Intersection.
- Existing Pavement Markings:** See Note #6 on KDOT TE700 regarding pavement markings. Existing pavement markings and pavement marking symbols in conflict with the proposed traffic control plan shall be removed by the Contractor during the initial traffic control setup for each sequence. Existing markings that are removed for the temporary traffic control shall be replaced per sequence during the transition between sequences.
- Vehicular accesses to remain OPEN through the work zone for the duration of construction:**
 - Parking Lot on North side of Antique Mall, Sta. 11+00, Left.
 - Capitol Federal Drive Thru, Sta. 25+25, Right.
 - Presbyterian Church Parking Lot, Sta. 35+50, Right.
 - Flinthills Laser Parking Lot, Sta. 39+25, Right.
 - State Farm Parking Lot, Sta. 40+30, Right.
 - Carlos Drive Thru, Sta. 41+55, Right.
 - Entrance into Emporia State University at 12th and Commercial (END of project baseline).
- Pedestrian access along the sidewalks on both the east and west side of Commercial Street shall be maintained for the duration of construction.** The Contractor shall not block/restrict pedestrian access on the north/south crosswalks at the side streets intersecting Commercial Street. Pedestrian access to at least one of the two east/west crosswalks crossing Commercial Street at each intersection shall be maintained at all times.
- Base Bid and Alternate Bidding:** These construction plans have been developed for the construction of the improvements from 5th to 12th Street in accordance with the Project Sequencing Plan (this sheet).
 - The Base Bid traffic control plan from 5th to 12th is intended to allow for a 3-block construction zone beginning at 12th Street and progressing south to 5th Street. The intent is to allow for the waterline to be installed in the 1st block (lead block) while service line installation is performed concurrently in the 2nd block (middle block) and pavement restoration is completed concurrently in the 3rd block (end block).
Anticipated Working Days: 1 week Pipe Installation per block.
1 week to Pressure Test and Disinfect.
5 days for services per block
 - The Alternate #1 traffic control plan from 5th to 12th is intended to allow the construction zone to extend from 5th to 12th with construction beginning at 12th Street and progressing south to 5th Street. The intent is to allow for the continuous installation of waterline along Commercial Street (K-99) in the event service line and pavement restoration does not progress as quickly as the water main installation.
Anticipated Working Days: Pipe Installation = 2.5 blocks per week.
1 week to Pressure Test and Disinfect per block.
5 days for services per block
 - The Alternate #2 traffic control plan from 5th to 12th is intended to restrict the construction zone to one block at a time beginning at 12th Street and progressing south to 5th Street. The intent is for the waterline to be installed, connections at the leading and lagging intersection to be made, all service lines installed, pavement restored and the major items of work within that block substantially complete prior to moving the construction zone and restricting the parking in the next sequential block.
Anticipated Working Days: 1 week Pipe Installation.
1 week Pressure Test and Disinfect.
5 days for services per block

PROJECT SEQUENCING PLAN

- Sequence #1: (Beginning of construction sequencing, all work in 1100 block)
- Bore casing from SE corner 12th/Commercial to NE corner 12th/Commercial.
 - Make connection to existing 12" Waterline (E/W).
 - Construct proposed 10" waterline south on Commercial from 12th to 11th.
 - Make connection to existing east/west waterline at 11th and Commercial.
- Sequence #2: (work zone spread out to 2 blocks)
- 1100 block: Pressurize/Disinfect/Flush/make service connections.
 - 1000 block: Construct proposed 10" waterline south on Commercial from 11th to 10th.
 - Make connection to existing east/west waterline at 11th and Commercial.
- Sequence #3: (work zone spread out to 3 blocks)
- 1100 block: Restore Pavement.
 - 1000 block: Pressurize/Disinfect/Flush/make service connections.
 - 900 block: Construct proposed 10" waterline south on Commercial from 10th to 9th.
 - Make connection to existing east/west waterline at 9th and Commercial.
- Continue construction similar to sequence #3 continuing a 3-block "moving" work zone (Base Bid Traffic Control) to the south until construction is complete.

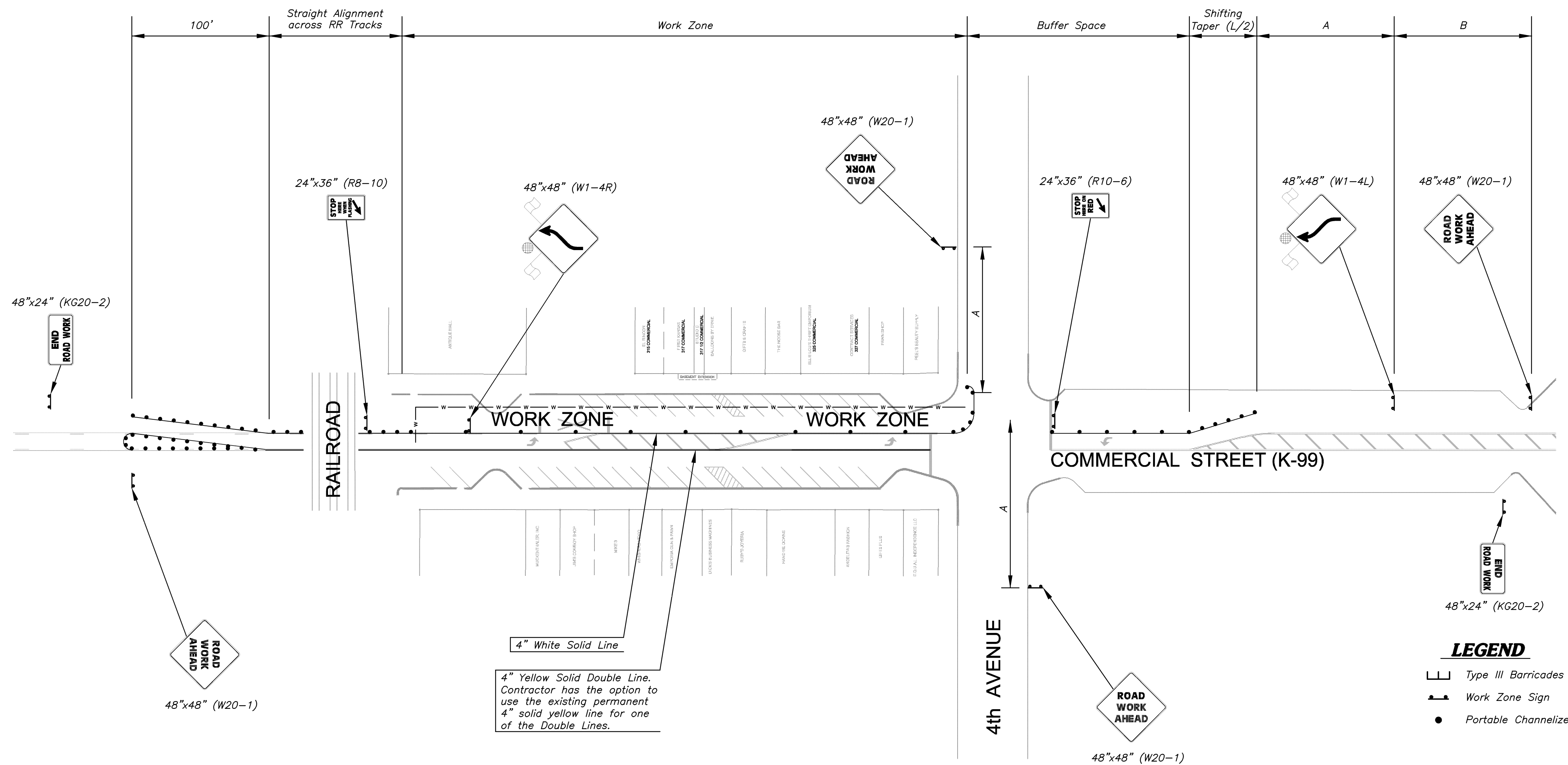
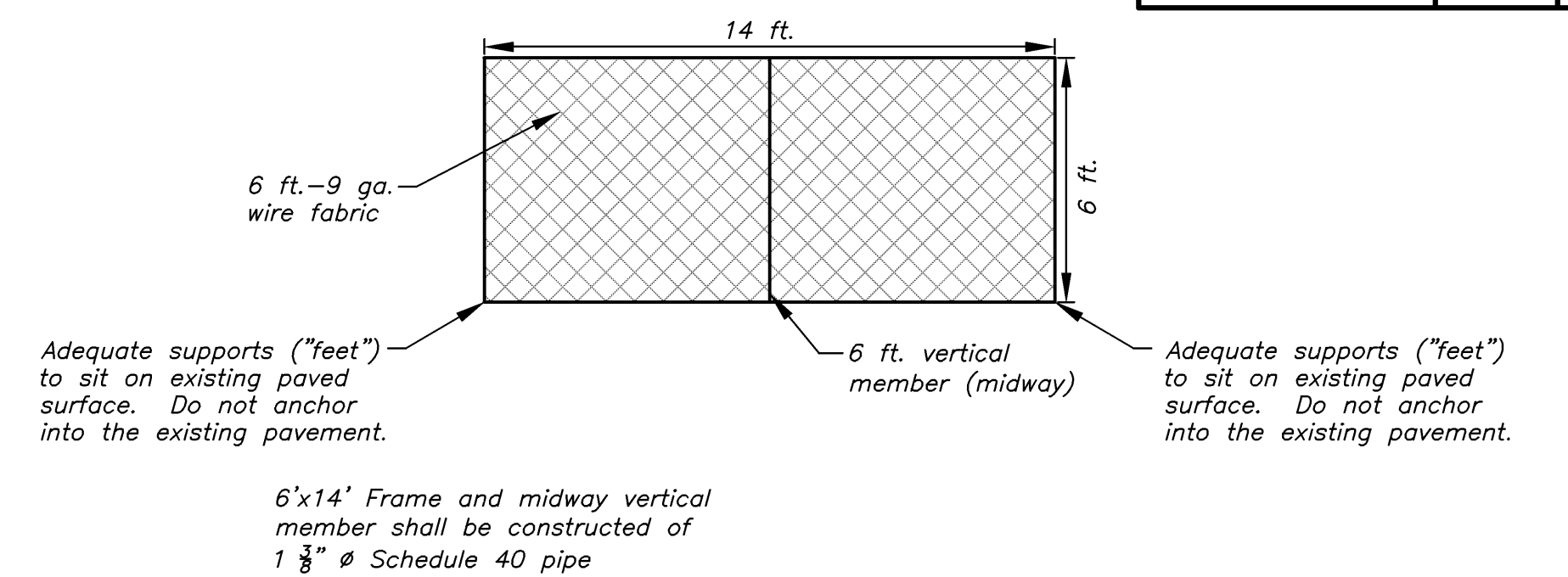

- LEGEND**
- Type III Barricades
 - Work Zone Sign
 - Portable Channelizer

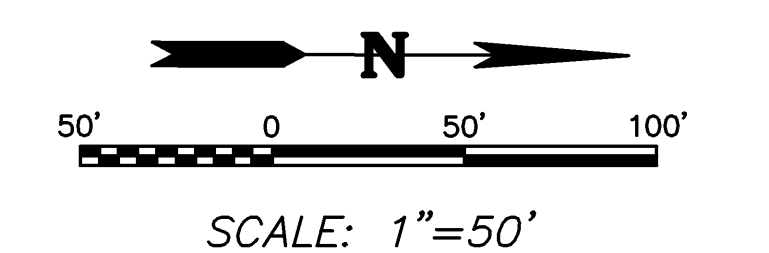

TRAFFIC CONTROL 1

